

Push Mount Clamps

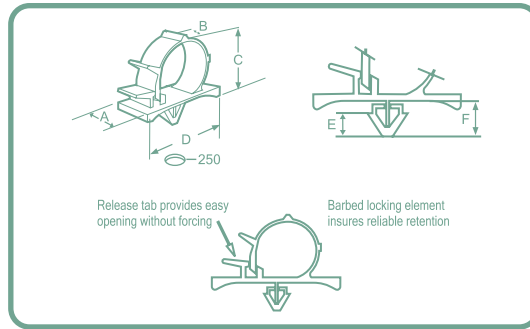

Can be used in a wide variety of environmental conditions and on any surface up to .080" thick. Just snap into a .250" hole and the push-mount will hold a 25 lb. continuous load and a 50 lb. impact load. Unique lock/release feature operates easily and locks securely.

Available in 94V-0 polypropylene for an additional charge. Add-V0 suffix to part number when ordering.

For use with chassis and panels .020" to .080" thick.

Part No.	A	B	C	D	E	F	Max. Bundle Diameter
029-0188	.55	1.00	.39	.38	.20	.30	3/16
029-0250	.58	1.00	.44	.41	.20	.30	1/4
029-0375	.65	1.00	.53	.50	.20	.30	3/8
029-0500	.77	1.19	.72	.60	.20	.30	1/2
029-0750	.88	1.38	.97	.67	.20	.30	3/4
029-1000	1.37	1.88	1.30	1.00	.20	.30	1

*Need more solutions?
Check out Push-in Fasteners and Rivets
on pages 94–106
and our Wire Management section
on pages 202–208.*