

# Delrin Thumb Screw Knobs

As easy as 1-2-3. Pick a head style (knurled, rosette or tee); add a standard socket head cap screw, choose your method of cold-pressing them together. Say the magic words and presto! - you've got an instant thumb screw knob.

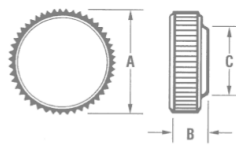

**KNURLED KNOB**



**TEE KNOB**

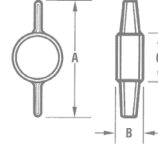

**ROSETTE KNOB**

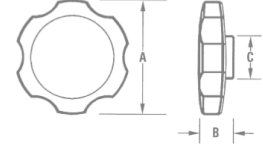

Part No.	Head Style	Fits Screw #	A (fraction)	A (In)	A (mm)	B (fraction)	B (In)	B (mm)	C (fraction)	C (In)	C (mm)
TK-1	Knurled	4	5/16	0.313	7.95	11/64	0.172	4.37	9/32	0.281	7.14
TK-2	Knurled	6	3/8	0.375	9.53	3/16	0.188	4.78	21/64	0.328	8.33
TK-3	Knurled	8	1/2	0.500	12.70	7/32	0.219	5.56	3/8	0.375	9.53
TK-4	Knurled	10	5/8	0.625	15.88	1/4	0.250	6.35	27/64	0.422	10.72
TK-5	Knurled	1/4	3/4	0.750	19.05	5/16	0.313	7.95	1/2	0.500	12.70
TK-6	Knurled	1/4	1	1.000	25.40	5/16	0.313	7.95	1/2	0.500	12.70
TK-7	Knurled	5/16	1	1.000	25.40	13/32	0.406	10.31	19/32	0.297	7.54
TK-8	Rosette	1/4	1-1/2	1.500	38.10	15/32	0.469	11.91	17/32	0.266	6.76
TK-9	Rosette	5/16	1-1/2	1.500	38.10	13/32	0.406	10.31	37/64	0.578	14.68
TK-10	Rosette	3/8	1-1/2	1.500	38.10	15/32	0.469	11.91	45/64	0.703	17.86
TK-11	Tee	10	1	1.000	25.40	1/4	0.250	6.35	7/16	0.438	11.13
TK-12	Tee	1/4	1-1/4	1.250	31.75	5/16	0.313	7.95	33/64	0.516	13.11
TK-13	Tee	5/16	1-1/2	1.500	38.10	13/32	0.406	10.31	5/8	0.625	15.88
TK-14	Tee	3/8	1-3/4	1.750	44.45	15/32	0.469	11.91	23/32	0.719	18.26

Minimum order 100.

Stock colour: Black. Also available in red, gray and yellow.

Metric sizes available.

**Countless Possibilities, Millions Of Solutions**  
**(416) 242-6811**