

Used to mount liquid tight conduit or tubing securely into place, vertically or horizontally.  
 Only fingertip pressure is required. Low profile design for pleasing appearance and space saving.  
 Recommended distance between brackets: intervals not greater than 3 ft.  
 Use one standard #10 screw (not included) to attach bracket to panel or chassis.

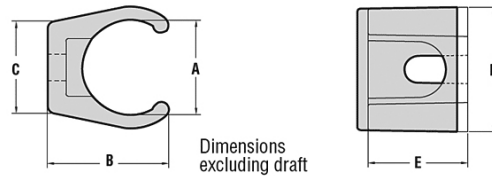

Part No.	Trade Size (fraction)	Trade Size (In)	Trade Size (mm)	A Inside Diameter (In)	A Inside Diameter (mm)	B Length (In)	B Length (mm)	C Height (In)	C Height (mm)	D Outside Diameter (In)	D Outside Diameter (mm)	E Width (In)	E Width (mm)
HFB3/8	3/8	0.375	9.53	0.710	18.03	0.910	23.11	0.690	17.53	0.910	23.11	0.750	19.05
HFB1/2	1/2	0.500	12.70	0.840	21.34	1.070	27.18	0.700	17.78	1.050	26.67	0.750	19.05
HFB3/4	3/4	0.750	19.05	1.050	26.67	1.260	32.00	0.730	18.54	1.260	32.00	0.750	19.05
HFB1	1	1.000	25.40	1.320	33.53	1.510	38.35	0.890	22.61	1.520	38.61	0.750	19.05

Standard Colour: Black. Gray also available.

**Countless Possibilities, Millions Of Solutions**  
**(416) 242-6811**