

Nylon Cap Nuts: Standard

Part No.	F (in)	F (mm)	D (in)	D (mm)	H (in)	H (mm)
CN-4/40	0.250	6.35	0.275	6.99	0.280	7.11
CN-6/32	0.305	7.75	0.350	8.89	0.345	8.76
CN-8/32	0.330	8.38	0.385	9.78	0.375	9.53
CN-10/24	0.365	9.27	0.420	10.67	0.400	10.16
CN-10/32	0.365	9.27	0.420	10.67	0.400	10.16
CN-1/4-20*	0.425	10.80	0.510	12.95	0.475	12.07
CN-5/16-18	0.500	12.70	0.575	14.61	0.530	13.46
CN-3/8-16	0.560	14.22	0.630	16.00	0.620	15.75
CN-1/2-13	0.750	19.05	0.860	21.84	0.810	20.57
CN-5/8-11	0.925	23.50	1.050	26.67	1.000	25.40

Minimum order 100

*No washer face

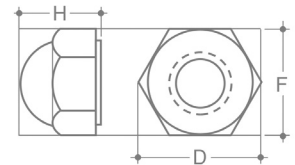
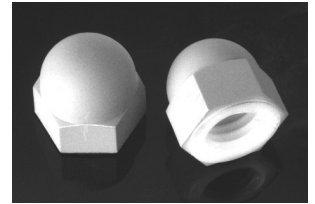

Countless Possibilities, Millions Of Solutions
(416) 242-6811