

Type 1: Flush front

Type 2: Recessed front

Snap-In Plugs are tough, flexible “finishing” plugs used extensively in all sheet metal work to seal access holes. Insertion is a snap. Thanks to an internal bead, they hold on tight when the handling gets tough.

Snap-In Plugs are used by auto rustproofers, on refrigeration units, water heaters, steel doors, paint cans, lawn mowers—even piggy banks!

These can be hot stamped with your logo to provide a unique and attractive solution for product identification. Call us for a quote on hot stamping.



Type 1 (Flush)

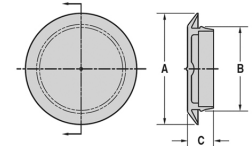

Type 1 (Flush)



Type 2 (Recessed)

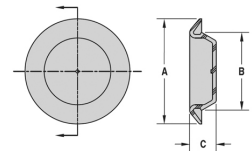

Type 2 (Recessed)

Type 1 (Flush – Fits 14-26 gauge material)

Part No.	Fits Hole Size (fraction)	Fits Hole Size (In)	Fits Hole Size (mm)	A (fraction)	A (In)	A (mm)	B (In)	B (mm)	C (In)	C (mm)	D (In)	D (mm)	E (In)	E (mm)	F (In)	F (mm)
NIA-659*	3/8	0.375	9.53	3/4	0.750	19.05	0.410	10.41	0.375	9.53	0.310	7.87	0.090	2.29	0.060	1.52
NIA-659-1	3/8	0.375	9.53	3/4	0.750	19.05	0.410	10.41	0.375	9.53	0.305	7.75	0.090	2.29	0.125	3.18
NIA-411	1/2	0.500	12.70	7/8	0.875	22.23	0.540	13.72	0.500	12.70	0.400	10.16	0.110	2.79	0.090	2.29
NIA-430	5/8	0.625	15.88	1-1/16	1.063	27.00	0.675	17.15	0.615	15.62	0.500	12.70	0.090	2.29	0.100	2.54
NIA-430-S	5/8	0.625	15.88	13/16	0.813	20.65	0.675	17.15	0.625	15.88	0.545	13.84	0.140	3.56	0.080	2.03
NIA-437	11/16	0.688	17.46	1-1/16	1.063	27.00	0.710	18.03	0.680	17.27	0.556	14.12	0.094	2.39	0.094	2.39
NIA-412	3/4	0.750	19.05	1	1.000	25.40	0.790	20.07	0.750	19.05	0.625	15.88	0.100	2.54	0.090	2.29
NIA-438	7/8	0.875	22.23	1-5/32	1.156	29.36	0.910	23.11	0.875	22.23	0.750	19.05	0.100	2.54	0.090	2.29
NIA-413	1	1.000	25.40	1-7/16	1.438	36.53	1.070	27.18	1.010	25.65	0.875	22.23	0.110	2.79	0.094	2.39
NIA-465	1-3/32	1.094	27.78	1-5/16	1.313	33.35	1.150	29.21	1.090	27.69	1.000	25.40	0.125	3.18	0.080	2.03
NIA-457	1-3/16	1.188	30.16	1-9/16	1.563	39.70	1.240	31.50	1.200	30.48	1.050	26.67	0.100	2.54	0.100	2.54
NIA-414	1-1/4	1.250	31.75	1-5/8	1.625	41.28	1.290	32.77	1.250	31.75	1.125	28.58	0.110	2.79	0.090	2.29
NIA-415	1-1/2	1.500	38.10	1-7/8	1.875	47.63	1.540	39.12	1.500	38.10	1.400	35.56	0.110	2.79	0.090	2.29
NIA-416	1-3/4	1.750	44.45	2-1/8	2.125	53.98	1.790	45.47	1.750	44.45	1.620	41.15	0.105	2.67	0.094	2.39
NIA-417	2	2.000	50.80	2-7/16	2.438	61.93	2.080	52.83	2.020	51.31	1.875	47.63	0.100	2.54	0.094	2.39
NIA-419	2-1/2	2.500	63.50	3	3.000	76.20	2.580	65.53	2.520	64.01	2.375	60.33	0.100	2.54	0.094	2.39
NIA-472	2-5/8	2.625	66.68	3-1/8	3.125	79.38	2.675	67.95	2.645	67.18	2.520	64.01	0.100	2.54	0.094	2.39
NIA-421	3	3.000	76.20	3-3/8	3.375	85.73	3.060	77.72	3.000	76.20	2.850	72.39	0.110	2.79	0.090	2.29

Countless Possibilities, Millions Of Solutions
(416) 242-6811

NIA-425*	4	4.000	101.60	4-1/2	4.500	114.30	4.100	104.14	4.020	102.11	3.900	99.06	0.150	3.81	0.080	2.03
NIA-425-S*	4	4.000	101.60	4-1/2	4.500	114.30	4.100	104.14	4.020	102.11	3.900	99.06	0.090	2.29	0.340	8.64

Type 2 (Recessed)

Part No.	Fits Hole Size (fraction)	Fits Hole Size (In)	Fits Hole Size (mm)	A (fraction)	A (In)	A (mm)	B (In)	B (mm)	C (In)	C (mm)	D (In)	D (mm)	E (In)	E (mm)	F (In)	F (mm)
NIA-411-2	1/2	0.500	12.70	7/8	0.875	22.23	0.538	13.67	0.500	12.70	0.430	10.92	0.125	3.18	0.285	7.24
NIA-412-2	3/4	0.750	19.05	1-5/32	1.156	29.36	0.800	20.32	0.750	19.05	0.660	16.76	0.170	4.32	0.360	9.14
NIA-438-2	7/8	0.875	22.23	1-1/4	1.250	31.75	0.915	23.24	0.875	22.23	0.795	20.19	0.155	3.94	0.350	8.89
NIA-413-2	1	1.000	25.40	1-3/8	1.375	34.93	1.050	26.67	1.000	25.40	0.930	23.62	0.160	4.06	0.350	8.89
NIA-465-2	1-3/32	1.094	27.79	1-7/16	1.438	36.53	1.125	28.58	1.090	27.69	1.000	25.40	0.160	4.06	0.350	8.89
NIA-414-2	1-1/4	1.250	31.75	1-5/8	1.625	41.28	1.308	33.22	1.250	31.75	1.170	29.72	0.140	3.56	0.350	8.89
NIA-415-2	1-1/2	1.500	38.10	1-7/8	1.875	47.63	1.550	39.37	1.500	38.10	1.420	36.07	0.150	3.81	0.370	9.40
NIA-418-2	1-5/8	1.625	41.28	2	2.000	50.80	1.675	42.55	1.625	41.28	1.540	39.12	0.160	4.06	0.350	8.89
NIA-416-2	1-3/4	1.750	44.45	2-1/8	2.125	53.98	1.800	45.72	1.750	44.45	1.670	42.42	0.160	4.06	0.350	8.89
NIA-417-2	2	2.000	50.80	2-3/8	2.375	60.33	2.050	52.07	2.000	50.80	1.910	48.51	0.180	4.57	0.360	9.14
NIA-419-2	2-1/2	2.500	63.50	3	3.000	76.20	2.570	65.28	2.500	63.50	2.400	60.96	0.160	4.06	0.380	9.65
NIA-421-2	3	3.000	76.20	3-1/2	3.500	88.90	3.060	77.72	3.000	76.20	2.910	73.91	0.190	4.83	0.410	10.41

Minimums available on request.

Black Low Density Polyethylene.

Tolerances on all decimal dimensions are $\pm .010$ per inch (example: $2.500 \pm .010$ per inch = .025).

Tolerances for fractional dimensions are $\pm 1/32$ " per inch.

Heat distortion temperatures are as follows:

Low Density Polyethylene: 100-121°F (66 P.S.I.)

Medium Density Polyethylene: 120-165°F (66 P.S.I.)

High Density Polyethylene: 140-180°F (66 P.S.I.)

Countless Possibilities, Millions Of Solutions
(416) 242-6811

62 Densley Avenue, Toronto, Ontario Canada M6M 5E1

cordscanada.com