

Snap-In Liquid Tight Grommets

Gray moulded EPDM grommet is fire tested to FMVSS 302, vehicle safety norm 302 (DIN 75200) to provide light strain relief to the cable. Material hardness 50 shore A. Just snap into place, pierce thin membrane, insert and pull back cable. Protection Class IP 67 per EN60529.

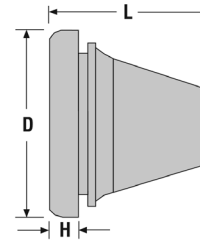

Part No.	Cable Diameter Range (In)	Cable Diameter Range (mm)	Panel Hole Diameter (In)	Panel Hole Diameter (mm)	Panel Thickness Range (In)	Panel Thickness Range (mm)	A Head Diameter (In)	A Head Diameter (mm)	B Head Thickness (In)	B Head Thickness (mm)	C Overall Length (In)	C Overall Length (mm)
LTB30-50	.12-.20	3.05-5.08	0.520	13.21	.04-.16	1.02-4.06	0.790	20.07	0.270	6.86	0.500	12.70
LTB50-70	.20-.28	5.08-7.11	0.630	16.00	.04-.16	1.02-4.06	0.790	20.07	0.230	5.84	0.790	20.07
LTB70-100	.28-.39	7.11-9.91	0.750	19.05	.04-.16	1.02-4.06	0.940	23.88	0.230	5.84	0.830	21.08
LTB100-140	.39-.55	9.91-13.97	0.910	23.11	.04-.16	1.02-4.06	1.100	27.94	0.250	6.35	0.930	23.62
LTB140-200	.55-.79	13.97-20.07	1.140	28.96	.04-.16	1.02-4.06	1.340	34.04	0.260	6.60	1.020	25.91
LTB200-260	.79-1.02	20.07-25.91	1.500	38.10	.04-.16	1.02-4.06	1.810	45.97	0.270	6.86	1.180	29.97
LTB260-350	1.02-1.38	25.91-35.05	1.890	48.01	.04-.16	1.02-4.06	2.260	57.40	0.310	7.87	1.420	36.07

Standard Colour: Gray

Countless Possibilities, Millions Of Solutions
(416) 242-6811