

Straight-Thru Liquid Tight Fitting

All nylon construction with BUNA-N compression gland resists salt water, weak acids, gasoline, alcohol, oil, grease and common solvents. Fittings install in either clearance or threaded holes. Acme threads prevent skipping and speed installation. The domed sealing nut resists snags and sheds contaminants. An internal ratchet provides self-locking against vibration. Working temperatures: -22°F (-30°C) to 212°F (100°C). For short periods to 302°F (150°C). Protection class IP 68 per DIN 40050 up to 70 psi (5 bar) water pressure. Available in metric.

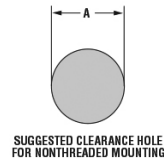
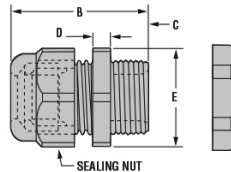

Installation Note: For optimum liquid tightness, use fitting with the smallest maximum diameter that will still fit your application.

NPT Hubs For Flexible Cords (Locknuts Not Included)

| Part No. | | Cable Dia. Range Min.-Max. (In) | Cable Dia. Range Min.-Max. (mm) | Thread Type & Size | A Clearance Hole (In) | A Clearance Hole (mm) | B Max. O.A. Length (In) | B Max. O.A. Length (mm) | C Thread Length (In) | C Thread Length (mm) | D Wrenching Nut Thick. (In) | D Wrenching Nut Thick. (mm) | E Wrenching Flats (In) | E Wrenching Flats (mm) |
|----------|--------|---------------------------------|---------------------------------|--------------------|-----------------------|-----------------------|-------------------------|-------------------------|----------------------|----------------------|-----------------------------|-----------------------------|------------------------|------------------------|
| Black | Grey | | | | | | | | | | | | | |
| †M4516 | †M4517 | .115 - .250 | 2.92-6.35 | 1/4-NPT | 0.540 | 13.72 | 1.280 | 32.51 | 0.450 | 11.43 | 0.210 | 5.33 | 0.630 | 16.00 |
| †M4514 | †M4515 | .065 - .210 | 1.65-5.33 | 1/4-NPT | 0.540 | 13.72 | 1.280 | 32.51 | 0.450 | 11.43 | 0.210 | 5.33 | 0.630 | 16.00 |
| 3228 | 3229 | .181 - .312 | 4.60-7.92 | 3/8-NPT | 0.670 | 17.02 | 1.490 | 37.85 | 0.530 | 13.46 | 0.200 | 5.08 | 0.750 | 19.05 |
| 3458 | 3459 | .069 - .187 | 1.75-4.75 | 3/8-NPT | 0.670 | 17.02 | 1.490 | 37.85 | 0.530 | 13.46 | 0.200 | 5.08 | 0.750 | 19.05 |
| 3200 | 3201 | .230 - .546 | 5.84-13.87 | 1/2-NPT | 0.875 | 22.23 | 1.830 | 46.48 | 0.620 | 15.75 | 0.200 | 5.08 | 0.950 | 24.13 |
| 3231 | 3232 | .170 - .470 | 4.32-11.94 | 1/2-NPT | 0.875 | 22.23 | 1.720 | 43.69 | 0.620 | 15.75 | 0.200 | 5.08 | 0.950 | 24.13 |
| 3234 | 3235 | .450 - .709 | 11.43-18.01 | 3/4-NPT | 1.068 | 27.13 | 1.970 | 50.04 | 0.630 | 16.00 | 0.230 | 5.84 | 1.300 | 33.02 |
| 3460 | 3461 | .250 - .485 | 6.35-12.32 | 3/4-NPT | 1.068 | 27.13 | 1.970 | 50.04 | 0.630 | 16.00 | 0.230 | 5.84 | 1.300 | 33.02 |
| †8437 | †8438 | .590 - 1.00 | 14.99-25.40 | 1-NPT | 1.350 | 34.29 | 2.410 | 61.21 | 0.750 | 19.05 | 0.280 | 7.11 | 1.650 | 41.91 |
| †M8439 | †M8440 | .472 - .787 | 11.99-19.99 | 1-NPT | 1.326 | 33.68 | 2.420 | 61.47 | 0.760 | 19.30 | 0.300 | 7.62 | 1.730 | 43.94 |
| †M4524 | †M4525 | .875 - 1.26 | 22.23-32.00 | 1-1/4-NPT | 1.680 | 42.67 | 2.690 | 68.33 | 0.780 | 19.81 | 0.300 | 7.62 | 2.050 | 52.07 |
| †M4522 | †M4523 | 0.787 - 1.020 | 19.99-25.91 | 1-1/4-NPT | 1.680 | 42.67 | 2.690 | 68.33 | 0.780 | 19.81 | 0.300 | 7.62 | 2.050 | 52.07 |

†US and Foreign Patents Pending.

Countless Possibilities, Millions Of Solutions
(416) 242-6811